



Fitting Instruction

Article-No. : 118T037RR
Product : Rear Set
Vehicle Manufacturer : Triumph
Model : Daytona 675

Important:

Read this instruction manual carefully and mind all warnings and tips. You should do this work only if you're qualified; otherwise we recommend this mounting to be done by a qualified workshop. Improperly mounting of this kit can reduce the driveability of the motorcycle and may be a risk to your health and life.

Special works are marked with the following signs. Please take special care on these works.



Warning! Important mounting instruction. It shows risks to your life and health.



Tips for mounting and maintenance or to avoid damage.

Fitting:

Remove stock rear sets. The following original parts will be used for your new rear set: gearbox lever



Rear sets are pre-assembled but all screws are not tightened! Always use locknuts or proper amount of medium thread-locking adhesive (e. g. Loctite 243). All details of assembling are shown on the backside drawing. All parts are welded into their bags as they belong together.



Side stand and sprocket cover are inapplicable.

The tightening torques for connections to the frame refers to the manufacturer's instructions. Use the following torques for all the other screw connections:

M5	=	6Nm	=	4.43lbf ft
M6	=	10Nm	=	7.38lbf ft
M8	=	20Nm	=	14.75lbf ft
M10x1.25	=	30Nm	=	22.13lbf ft



Test brake and gear shifting indoor after installing your new rear set. **If anything is not operating properly or braking efficiency is poor, testing on the road may result in death or serious injury!**

Maintenance:



Periodically proof all functions during service intervals. Use **particle free (no MoS₂)** lithium or barium soap grease to maintain lever bushings.

Screw in M8x20 from outside and mount brake cylinder on the inside

Original counternut M8

Mount ball joint instead of the original fork head on the push rod

Screw in M8x35 from lever outside and mount bushing (t=9mm) and ball joint on the inside with flat locknut M8

Mount brake pedal as shown in separate drawing for peg adapter

Fit the spring bolt (l=24,5 mm)

Fit the spring bolt (l= 16mm)

Brake cylinder adapter mounted with M6x16 on the outside

2x M8x20

2x M8x25

Fix brake lever knob with countersunk M6x16

Advice: The original sprocket cover is inapplicable, you can use our sprocket cover (part-no.: 712T037) alternatively.

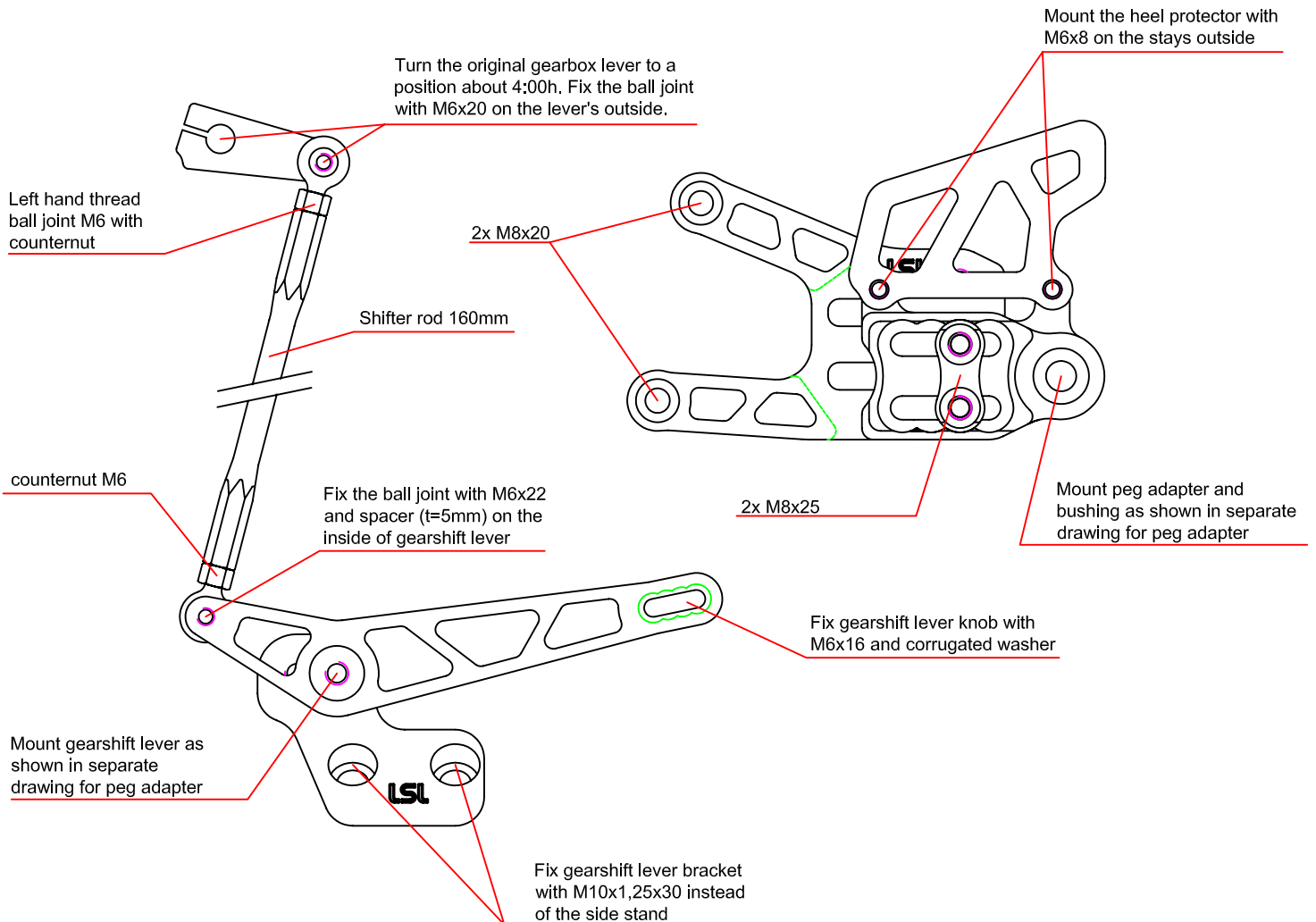

Rechte Seite / right side

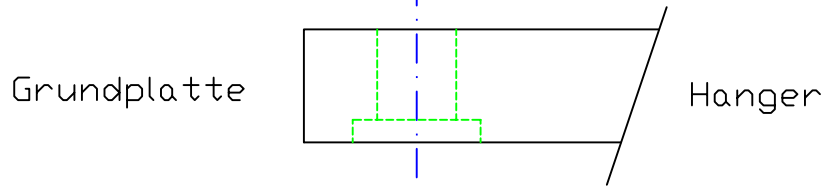
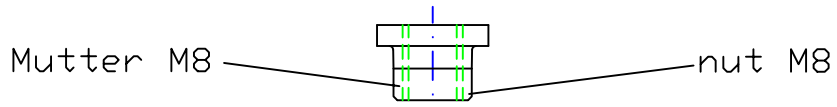

ggf. Paßscheibe verwenden
falls Hebel nicht beweglich

If lever is blocked use
shim ring

Scheibe $\varnothing 28\text{mm}$

Washer $\varnothing 28\text{mm}$



Brake pedal

Washer $\varnothing 25\text{mm}$

Fett

Grease

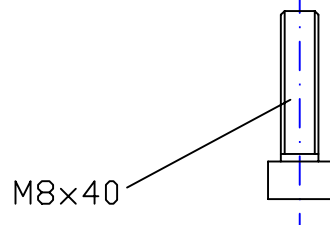
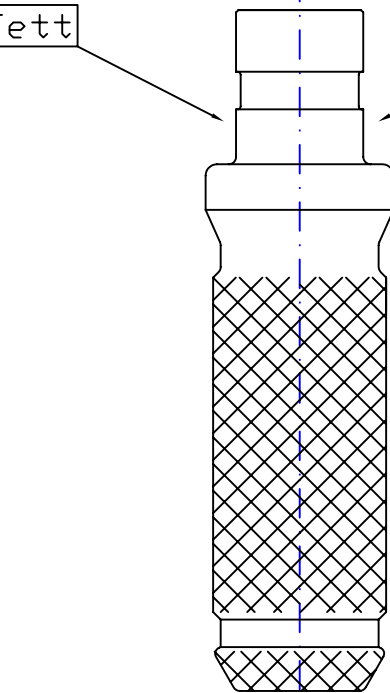

Linke Seite vorne / left front side

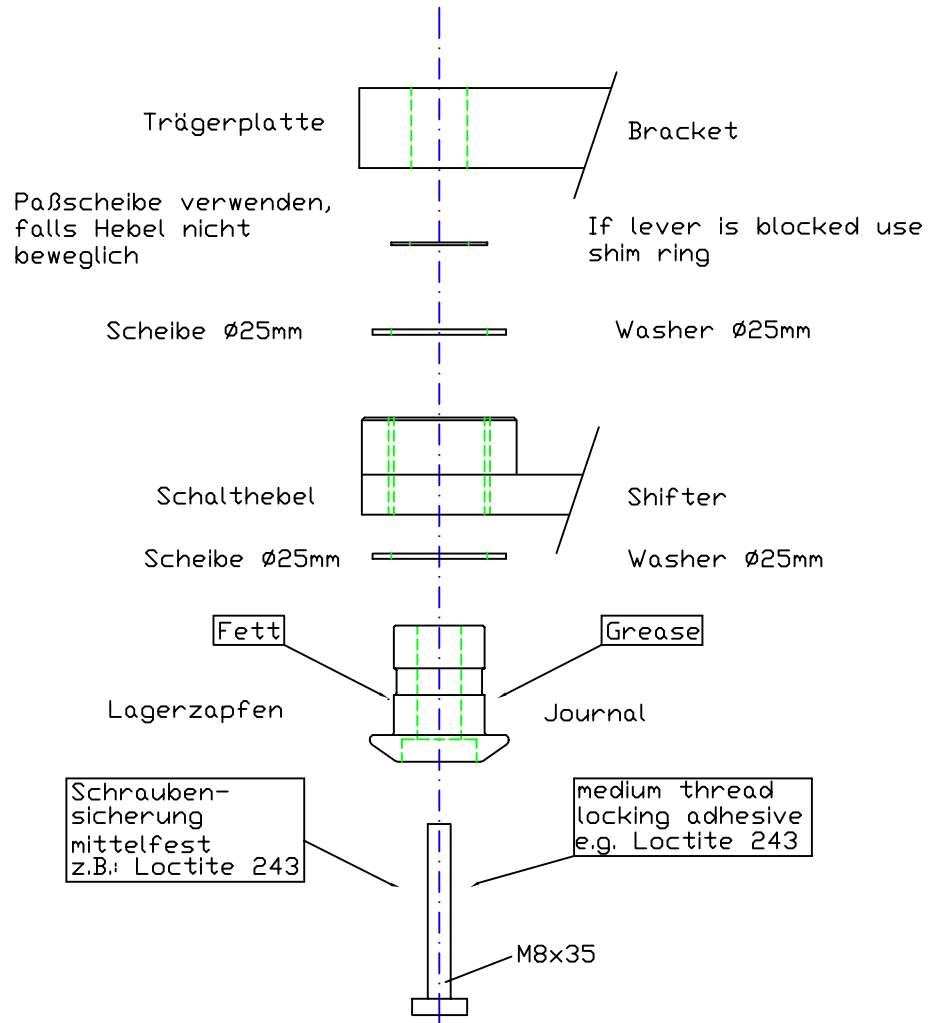

Linke Seite / Left side

